

Podest intermediar

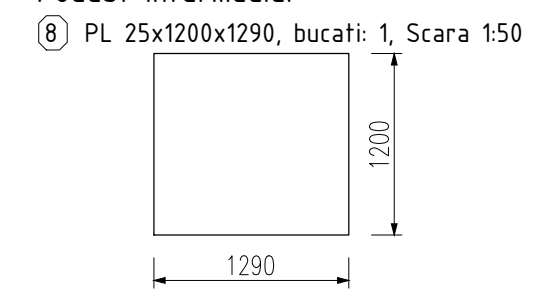

Podest de capat

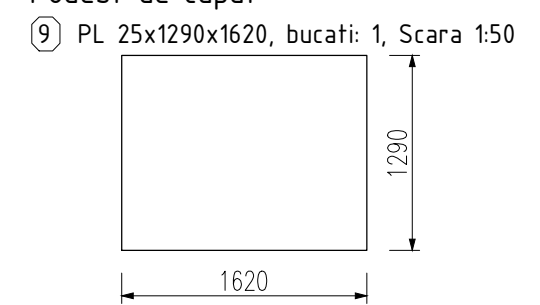

Treapta

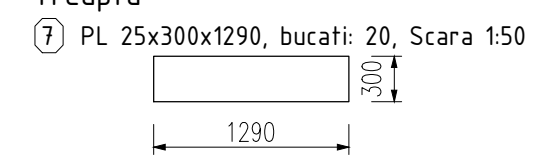

NOTA:
Treapele (marca 7) si podestul intermediar si de capat (marca 8 si 9) se vor realiza conform planselor de arhitectura si normelor in vigoare.

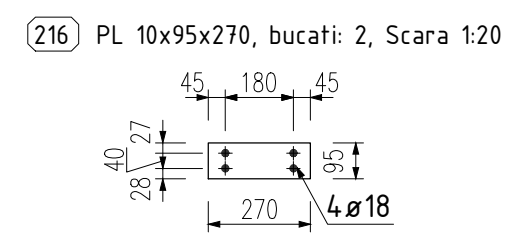
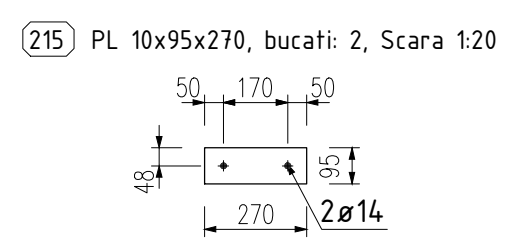
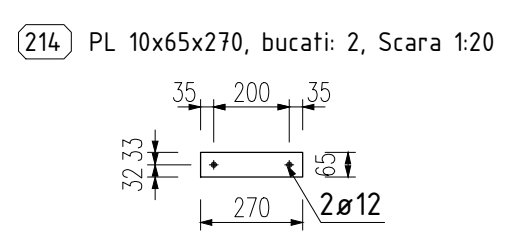
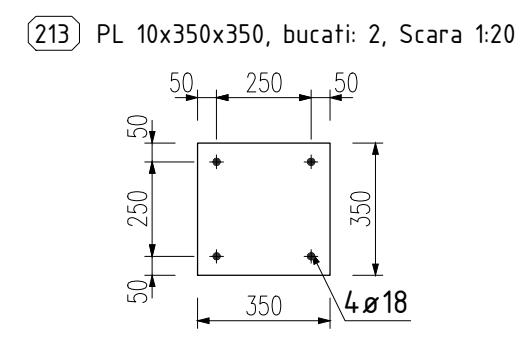
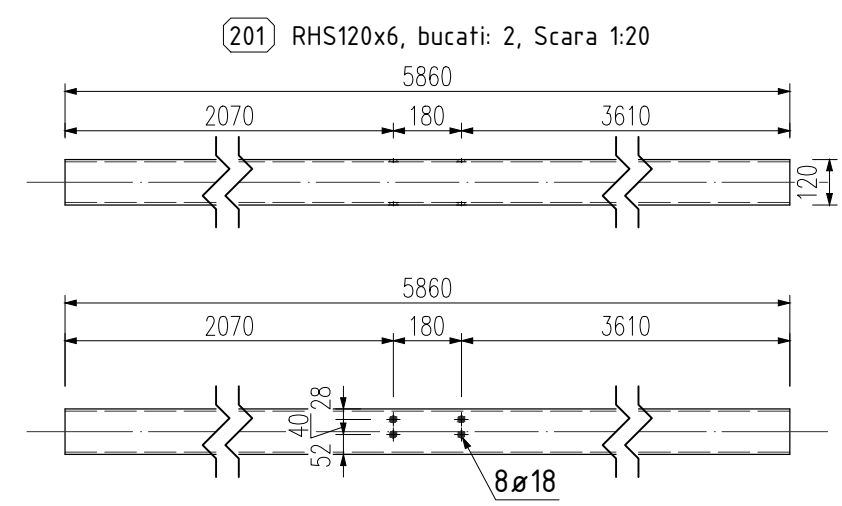

OTEL: S 355 JO
SR EN 10025:2004
SURUBURI:GRUPA 8.8

				A2	
VERIFICATOR/ EXPERT	NUME	SEMNATURA	CERINTA	REFERAT / EXPERTIZA NR./ DATA	
 s.c. DB PRO STRUCTURES s.r.l. C.U.I.RO36255978 Timisoara, str. J.H.Pestalozzi, J35/1901/29.06.2016 nr. 22, jud. Timis tel. +447715628445				Beneficiar:	COMUNA SPRING
				Nr. pr.	56/2022
SPECIFICATIE	NUME	SEMNATURA	Scara/Format: 1:50 1:20 /A3	Titlu proiect:	CONSTRUIRE SI DOTARE SCOALA PRIMARA SI GRADINITA IN SAT SPRING, COMUNA SPRING, JUDETUL ALBA
SEF PROIECT:	ing. Dontu Alexandru			Amplasament:	Județul Alba, Sat Spring, Comuna Spring, C.F. 91591
PROIECTAT :	ing. Mite Adrian		Data:	Titlu plansa:	DETALIERE ELEMENTE METALICE SCARA EXTERIOARA-partea 1
DESEANAT :	ing. Mite Adrian		2022	Nr. pl.	R.16